



Humidity sensor

TYPE MHT

Measurement of humidity



Humidity sensor type MHT is used for measuring of humidity in e.g. refrigeration plants, air-conditioning and ventilating plants and reefer units.

Type MHT uses a capacitive element for measuring. A micro-controller compensates for nonlinearity and fluctuation of temperature: In this way accurate measurements are guaranteed

Technical data

Supply voltage:	24V DC \pm 5VDC
Measuring range:	Output 4-20 mA: 20-100% Output 0-10 V : 0-100%
Absolute accuracy:	10-90% RH: \pm 4% RH 90-100% RH: \pm 6% RH
Additional RH uncertainty for temperature range:	0-10°C: \pm 1-2% RH 35-70°C: \pm 1-2% RH
Repetitive accuracy:	\pm 0.2% RH
Long-term stability:	<1% RH per year
Working temperature:	0 - 70°C
Storage temperature:	-40 / +80°C
Output signal:	4-20 mA or 0-10V EN 61000-4-2 EN 61000-4-4 EN 61000-4-6

A porous PTFE- membrane protects the sensor against water and dust. The membrane is placed in a way that leaves a very small volume between the membrane and the sensor. This ensures a fast response time and reduces the risk of saturation during condensing climate conditions.

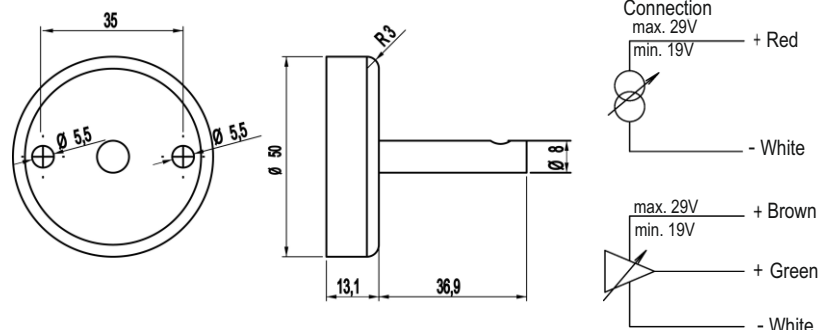

Ordering: See ordering form on back page



ORDERING FORM / HUMIDITY SENSOR TYPE MHT

Type-MHT

Length		PUR Cable	
Plane	1	1	2 m
With tuck-in	2	2	5 m

Output	
4-20 mA (20-100% RH)	1
0-10V (0-100% RH)	2

The diagram shows a 3-pin connector with three pins. The left and right pins are labeled '1' and '2' respectively. The central pin is labeled '1' and '2'.

Head office:

Senmatic A/S
Industrivej 8, 5471 Søndersø, Denmark
Phone: +45 64 89 22 11
dk@senmatic.com - www.senmatic.com