



# Resistance thermometer TYPE MI80

## Measuring insert



- The measuring insert - Form MI80 - DIN 43769 - is designed for Form B, when the protective sheath is  $\text{Ø}11 \times 1$  mm. For Form A, and for mounting with form B-head, without protecting tube.
- The measuring insert is mounted with a sensing element according to EN 60751.
- Between the element and the terminals of the plastic socket 2, 3 or 4 conductors are applied.
- The clamp socket is usually of plastic ( $200^{\circ}\text{C}$ ).
- The protecting tube is of stainless steel  $\text{Ø}8 \times 0.5$  mm.
- Recommended measuring current: max. 2 mA.

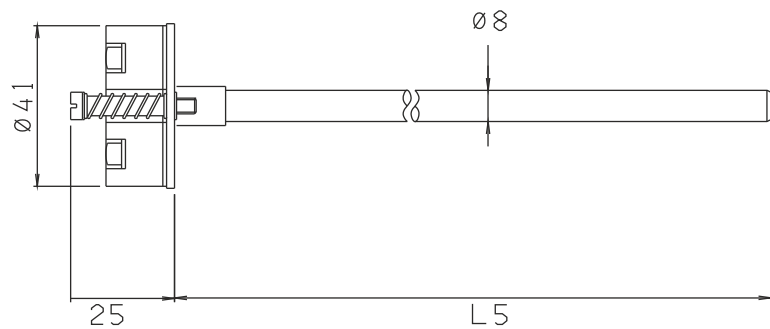

Ordering: See ordering form on back page



# ORDERING FORM / RESISTANCE THERMOMETER TYPE MI80

## Type MI80



V2.4

**Insert length/L5 in mm**  
 Min. 50 mm -  
 max. 800 mm  
 Optional length .....



**Temperature range**  
 1 .... -50 / +260°C  
 4 .... -50 / +400°C  
 For high temperature -  
 see type MMI

**Number of conductors**  
 2 cond. (Pt1000 only) .....  
 3 cond. ....  
 4 cond. ....  
 Prep. f. 3 cond. transm. ...  
 Prep. f. 4 cond. transm. ....

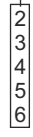

**Tolerance class/DIN**  
 1 ..... Cl. A : ±0.15 °C  
 2 ..... Cl. B : ±0.3 °C  
 3 ..... 1/3 DIN : ±0.1 °C  
 4 ..... 1/6 DIN : ±0.05 °C

**Number of elements**  
 1×Pt .....  
 2×Pt .....



**Resistance in ohms at 0°C**  
 ..... 100  
 ..... 500  
 ..... 1000

### Connection diagram:

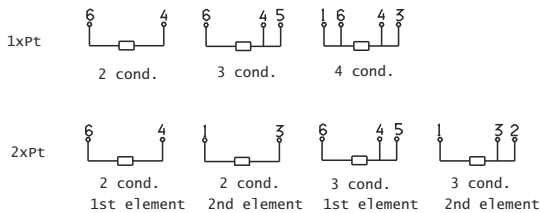

### Head office:

Senmatic A/S  
 Industrivej 8, 5471 Søndersø, Denmark  
 Phone: +45 64 89 22 11  
 dk@senmatic.com - www.senmatic.com